

QC1-FL2G-S23-01

1.0mm Connector, DC~110GHz

Features:
* Low VSWR

Applications:
* Wireless
* Radar
* Instruments
* Electronics

Electrical

Frequency: DC~110GHz
VSWR: 1.35 max.
Impedance: 50Ω

Mechanical

RF Connector: 1.0mm female
Outer Conductor: Passivated SUS303 stainless steel
Dielectric: ULTEM
Inner Conductor: Gold plated beryllium copper
Accept PIN: Φ0.23mm

Outline Drawings

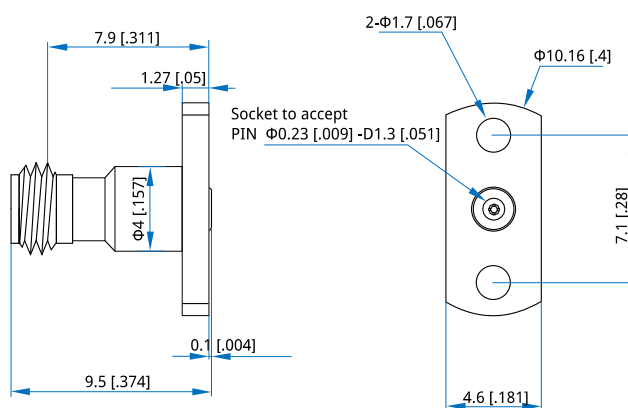

Unit: mm [in]

Tolerance: ±0.2mm [±0.008in]

How To Order

QC1-FL2G-S23-01

Customization is available upon request.